



## Size Chart & Measuring for Black Dog's Haltermate®

The Haltermate is a figure 8 style head halter, so you will get the most accurate size selection by measuring a dog's muzzle and neck in the way shown below - this is your dog's Figure 8 Measurement.

Alternatively, you could use the dog's neck measurement, this will give a reasonable estimate of the size to select.

We do not list sizes by breed type, or weight, because there can be large differences in muzzle size between individual dogs of the same breed.

### To determine the correct size...

Place a soft Tape Measure at the back of the dog's neck, then wrap it under the dog's jaw, around the muzzle and back under the jaw and around the back of the dog's neck as shown in the picture below.

Pull to a snug fit and write down this measurement. This is the dog's Figure 8 Measurement.

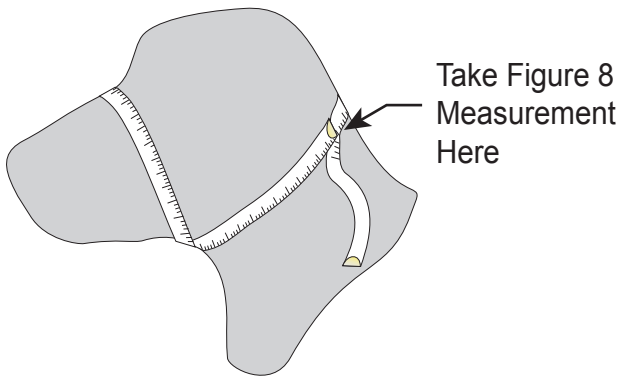

### Use your Figure 8 Measurement to Select the correct size Haltermate ...

#### Figure 8 Measurements

	Min (cm)	to	Max (cm)
<b>HM-Size 1 ...</b>	<b>33</b> (cm)	to	<b>47</b> (cm)
<b>HM-Size 2 ...</b>	<b>44</b> (cm)	to	<b>66</b> (cm)
<b>HM-Size 3 ...</b>	<b>57</b> (cm)	to	<b>84</b> (cm)
<b>HM-Size 4 ...</b>	<b>67</b> (cm)	to	<b>100</b> (cm)

### Or ... use this Neck Guide to get an estimate of the appropriate size

#### Neck Size Guide

	Min (cm)	to	Max (cm)
<b>HM-Size 1 ...</b>	<b>24</b> (cm)	to	<b>36</b> (cm)
<b>HM-Size 2 ...</b>	<b>28</b> (cm)	to	<b>40</b> (cm)
<b>HM-Size 3 ...</b>	<b>35</b> (cm)	to	<b>53</b> (cm)
<b>HM-Size 4 ...</b>	<b>40</b> (cm)	to	<b>65</b> (cm)

**Important:** If your dog's measurement is between 2 sizes, generally select the smaller size Haltermate, If you are fitting a young growing dog, then go for the larger size to account for future growth.

## Haltermate® Instructions

The Black Dog Haltermate is a figure 8 style Head Halter. It is a Flat Collar with a Tightening Loop, and a Noseband attached to the Loop. When fitted, the Noseband forms a figure 8 around the dog's muzzle/neck and when the Tightening loop is pulled, it tightens the Noseband over your dog's nose without pulling the head around.

### Fitting the Haltermate

- Adjust the Flat Collar to be a snug fit on your dog - fit the collar with the Tightening Loop at the back of your dog's neck.
- Now loop the Nose Band under and over your dog's muzzle to form a figure of 8. Start by taking the Noseband under the dog's jaw, then up and over the bridge of the nose just in front of the eyes (1), continue back down the other side of the face and under the jaw again (2) to complete a figure 8 loop around the face.
- Clip the Noseband into the Buckle on the Tightening Loop (3) and the halter is fitted.
- To check the Noseband adjustment, pull on the Tightening Loop - the Noseband should tighten and put pressure over your dog's nose while there is still about 2 to 5 cm between the ring and buckle in the loop.
- For stronger pressure, Shorten the noseband, or Lengthen it for less pressure. Generally set this set as light as your dog will respond to.
- If one of the plastic adjusters on the Noseband sits close to your dog's eye, slide the 2 plastic adjusters one way or the other. Then re-check the Noseband's fit.
- Attach a lead to the D Ring on the Tightening Loop and your dog is ready to go.
- Remember to reward your dog whenever you first fit the Halter and particularly during the 1st few weeks of using.

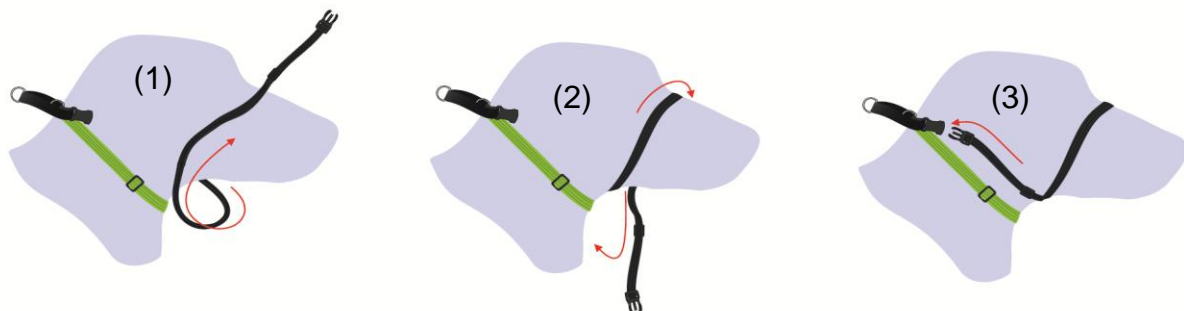

### Using the Haltermate

When walking your dog, only light to medium pressure is required on the lead as the Haltermate is extremely effective in calming a pulling, or boisterous dog. No need for harsh corrections, or gruff training techniques. If your dog pulls, apply pressure to the lead, then release, pressure, then release, (don't allow yourself to get into a "tug of war" with your dog). The moment your dog stops pulling, release pressure on the lead and praise and reward the dog's behaviour. We call this "Pulsating the Lead" – check out the Black Dog web site for more information [www.blackdog.net.au](http://www.blackdog.net.au).

The Haltermate gives you powerful control over your dog, but some dogs will resist this at first, it's like throwing a tantrum when they don't get what they want. If this happens it is best to ignore this behaviour, choose fun and engrossing things to do to distract your dog from focusing on the halter. Use food, or other rewards as your dog accepts wearing and walking on the Haltermate. It won't take long before you and your dog will both be enjoying walks, with your dog accepting and respecting your control.

When your dog is walking and responding well to the Haltermate, you can sometimes connect your lead to the Collar D Ring, to slowly train your dog to walk on a flat collar without pulling.

Don't leave the Halter on your dog once you have finished your walk and don't tether your dog from a Halter, clip onto your dog's normal collar for tethering.